



EvoHeat

WI-FI SET UP



InverterTemp app

WI-FI CONTROL SET UP

For Advanced DHP-R & Force-i series,
plus upgraded Fusion-i series



Contents

1. Introduction of the Wi-Fi Module.....	3
1.1 Spare Parts.....	3
1.2 Description of the Magic Controlling.....	3
2. Installation.....	4
2.1 Opening the Heat Pump.....	4
2.2 Connection.....	4
2.3 Reinstallation.....	5
3. Usage of the Wi-Fi Module.....	5
3.1 Wi-Fi Module Information.....	5
3.2 Downloading the Smartphone App.....	6
3.3 Register.....	7
3.4 Configuration.....	8
4. Operation & Use of the Smartphone App.....	10
4.1 Main Icons and Functions.....	10
4.2 Main Functions.....	11
4.2.1 Turning ON/OFF.....	11
4.2.2 Mode Shifting.....	11
4.2.3 Setting the Temperature.....	12
4.2.4 Timer Setting.....	12
4.2.5 Silence Mode.....	13
4.2.6 Timing Mute.....	13
4.2.7 Checking the Temperature Curve.....	13
4.3 Other Functions.....	14
5. FAQ.....	15



1. Introduction of the Wi-Fi Module

1.1 Spare Parts

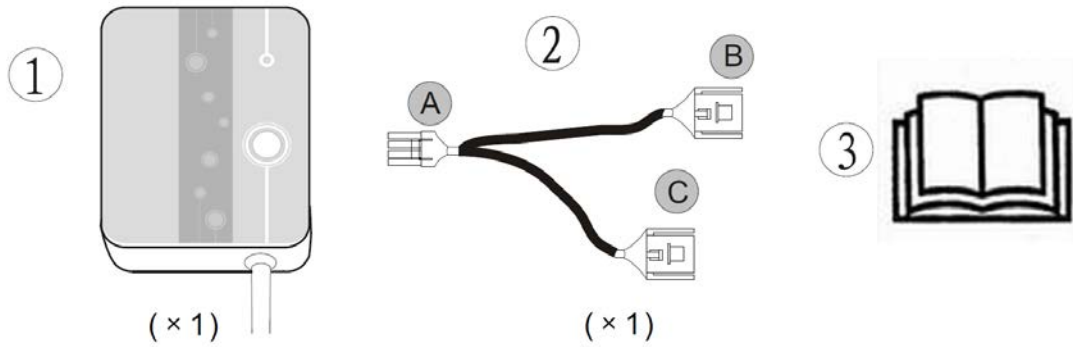

OR

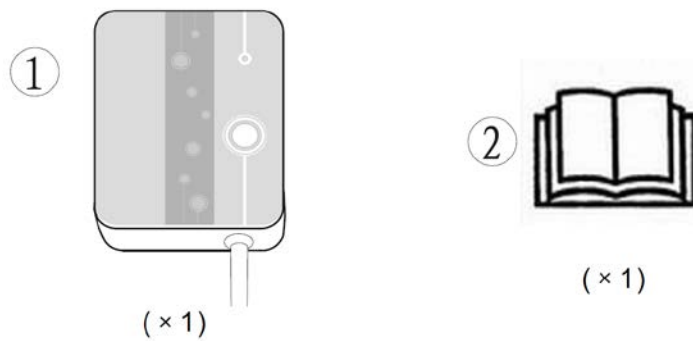

1.2 Description of the Magic Controlling

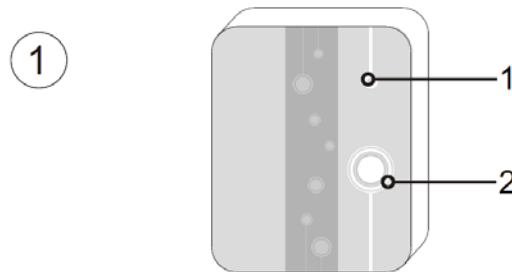

1	LED Lights (on=green)
2	Network Configuration Button

2

1. A constant blue light indicates the power in on.
2. A flashing blue light indicates Airlink connection configuration.
3. A constant green light indicates the unit is connected to the cloud or the phone.
4. A flashing green light indicates the unit is connected to the router.
5. A constant red light means there is no internet connection.

2. Installation

2.1 Opening the Heat Pump

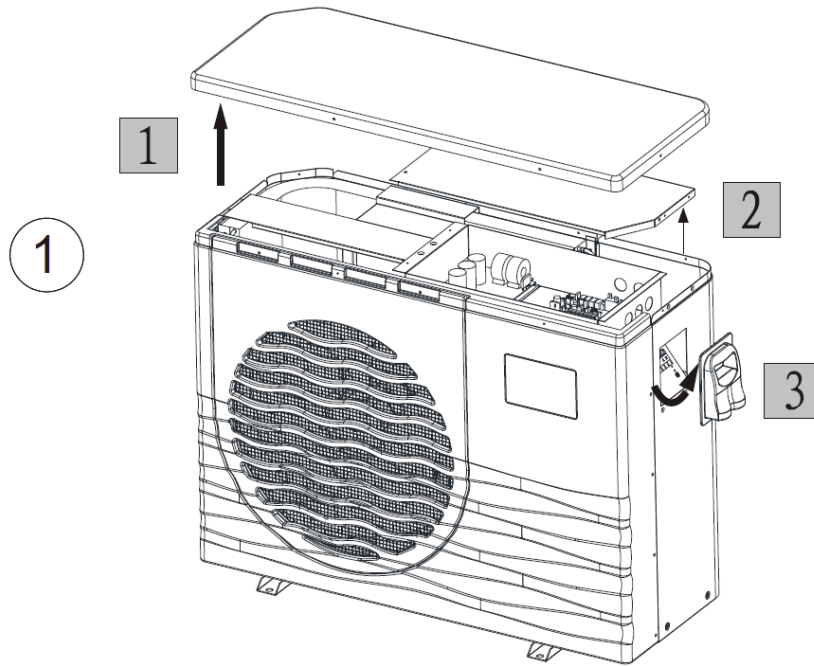

2.2 Connection

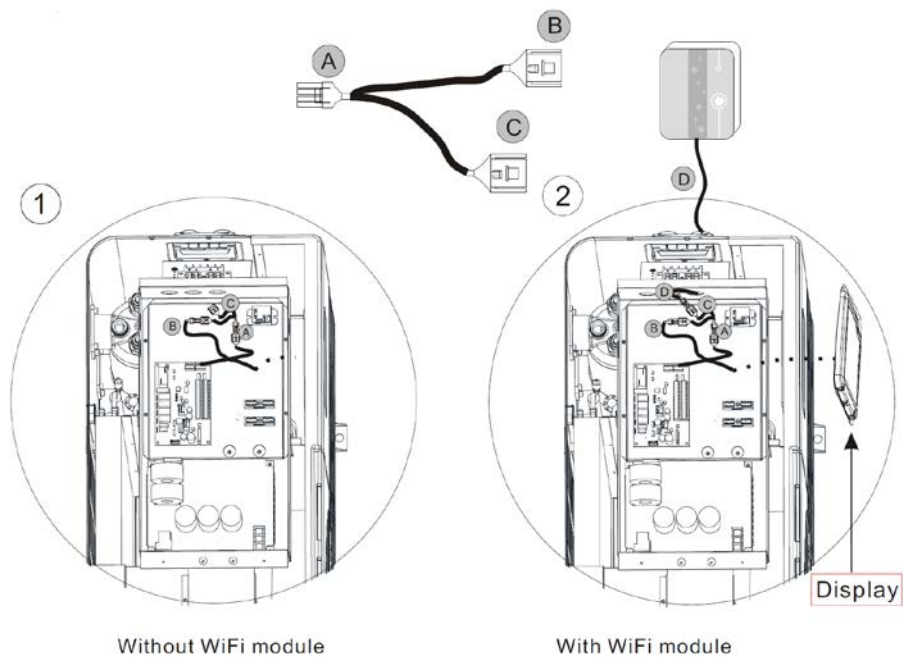

2.3 Reinstallation

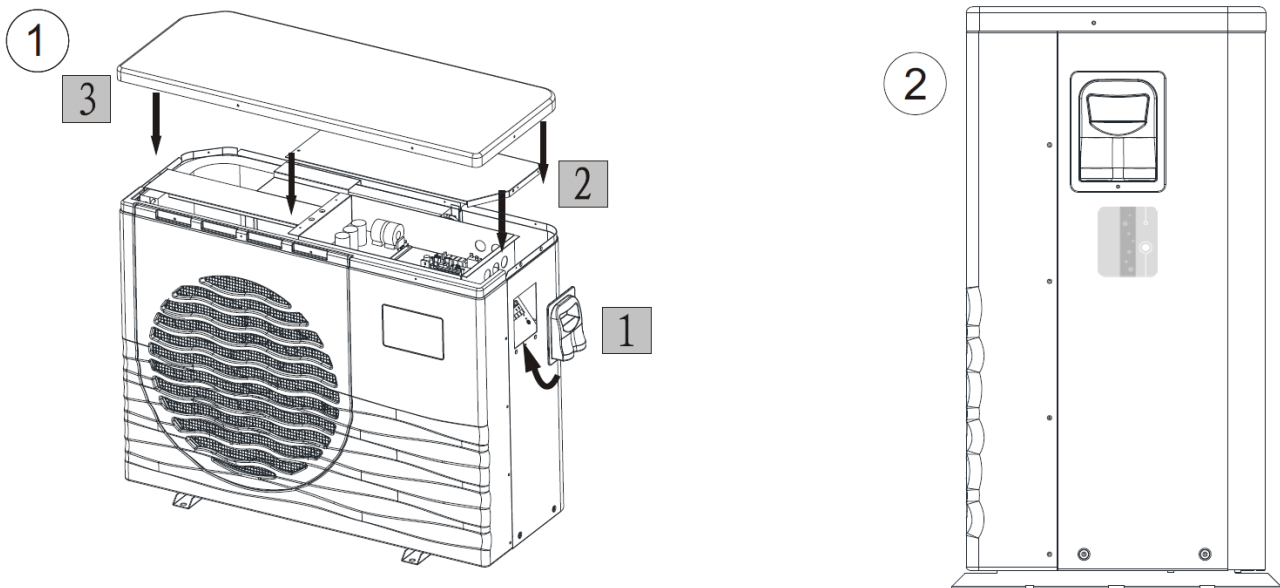

3. Usage of the Wi-Fi Module

3.1 Wi-Fi Module Information

NOTE: You need to prepare intelligent terminals (such as mobile devices), networks (such as routers) before you can achieve remote control.

Connections are as follows:

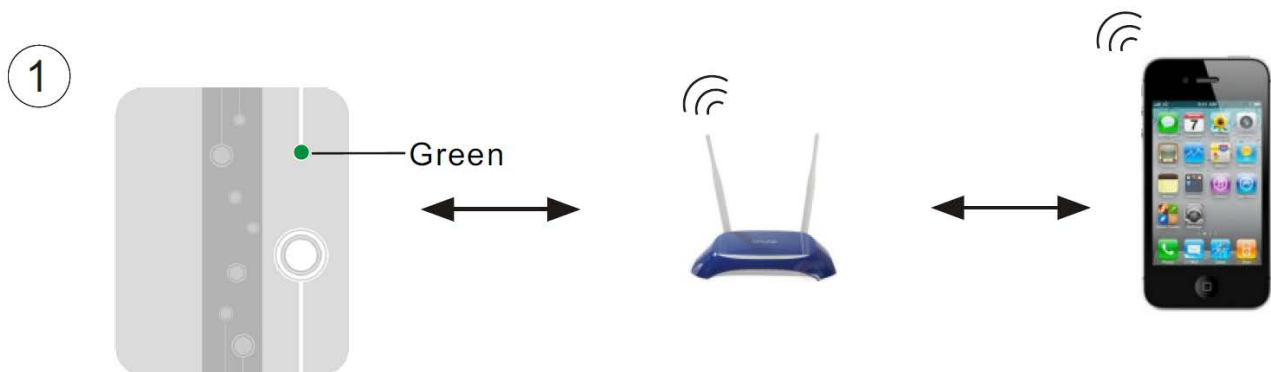

3.2 Downloading the Smartphone App

Android (Google Play Store)

Enter the Google Play Store and search for the InverterTemp program, then download and install it.



Google Play Store



InverterTemp
NB_Team.

3+

UNINSTALL

OPEN

This app is a heat pump, pool heater intelligent control software.

[READ MORE](#)



iOS (App Store)

Enter the App Store and search for the InverterTemp app, then download and install it.



App Store



Details

Reviews

Related

iPhone



3.3 Register

1

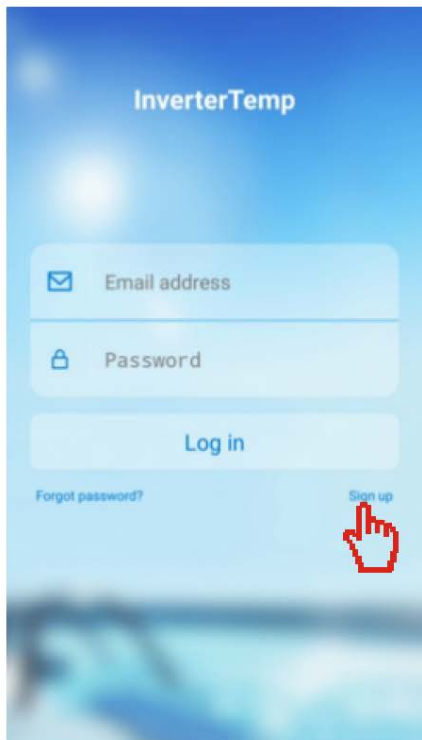

2

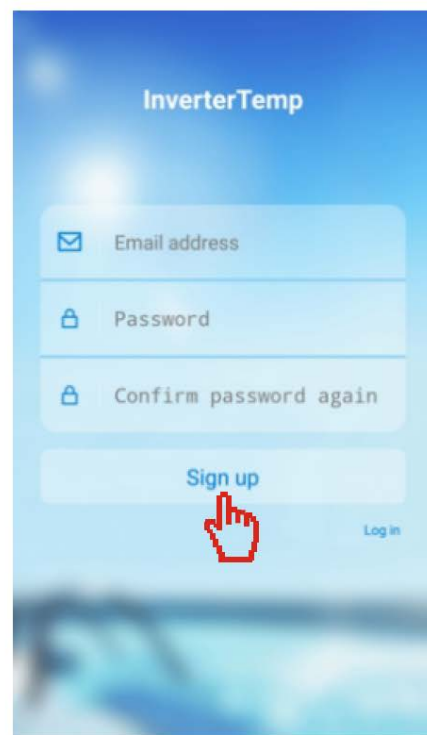

3

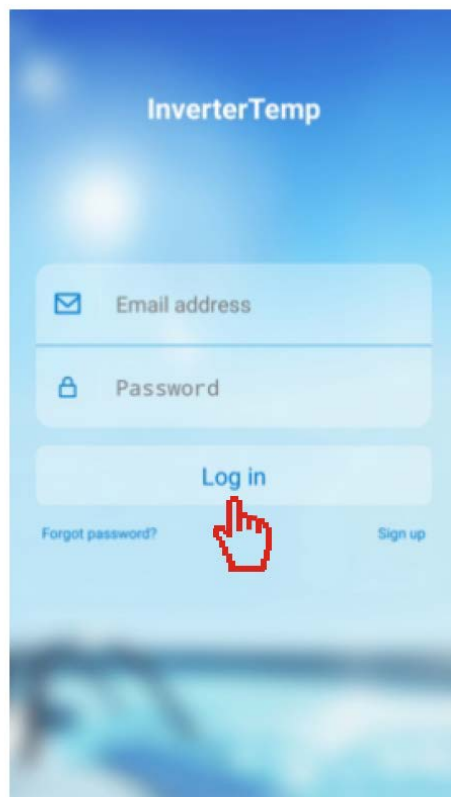

3.4 Configuration

NOTE: Confirm that the App has been connected to the correct Wi-Fi.

Input the correct password, then press to the next step.

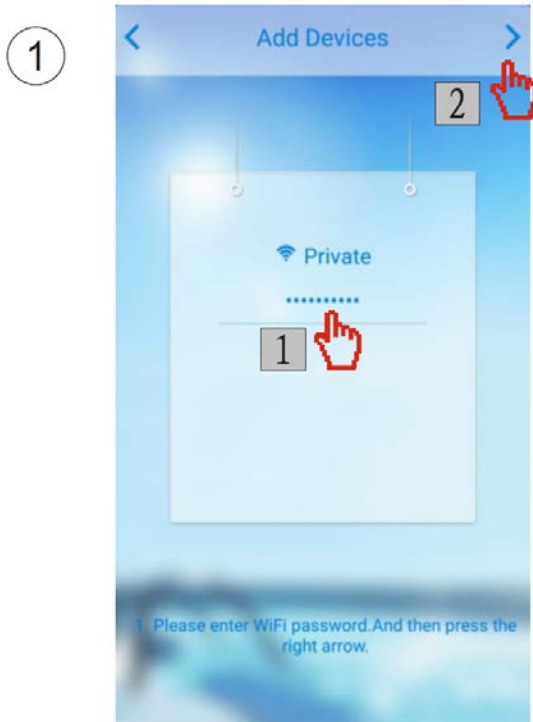

Press the button of the Wi-Fi module as below



After pressing the button, the light will turn blue

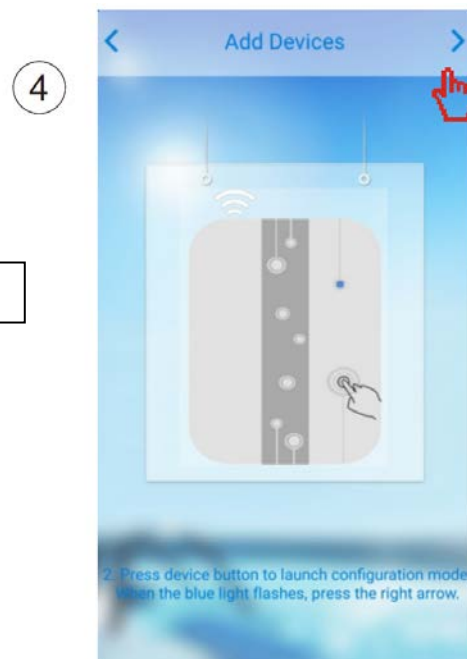
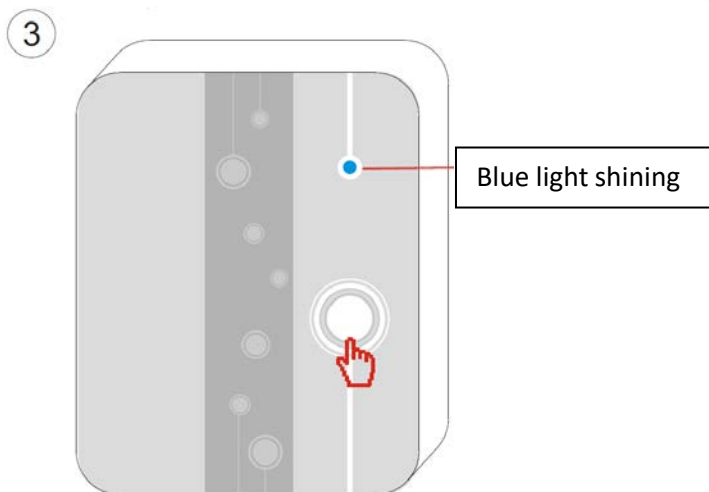

NOTE: on Wi-Fi module

Reading Configuration

5

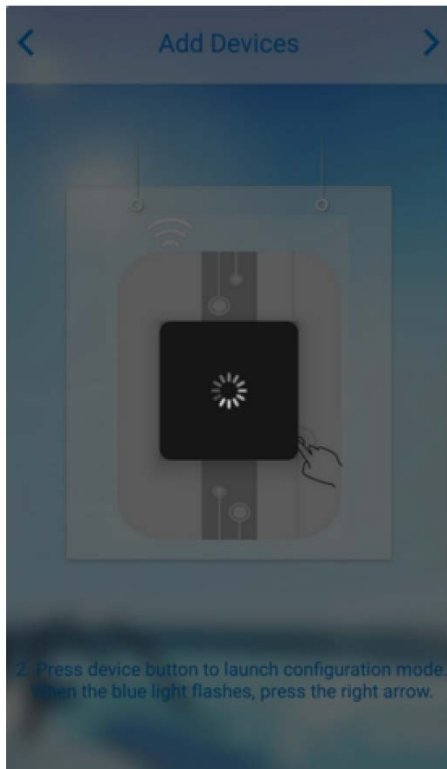

Successful Configuration

6



Loading Configuration Failed

7

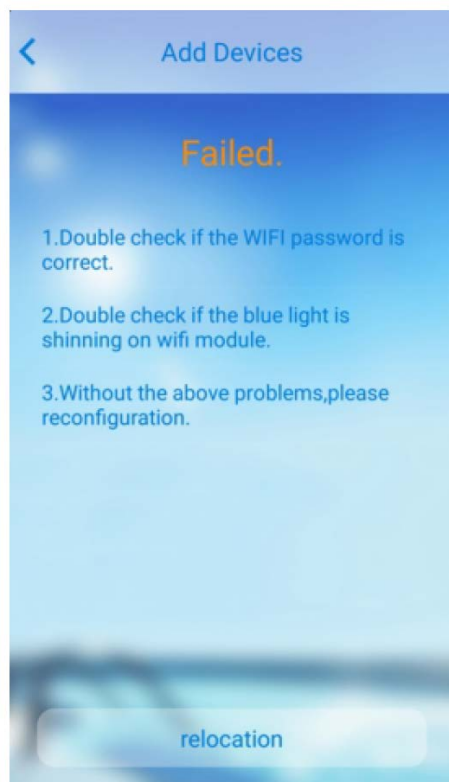

Reconfiguration

8

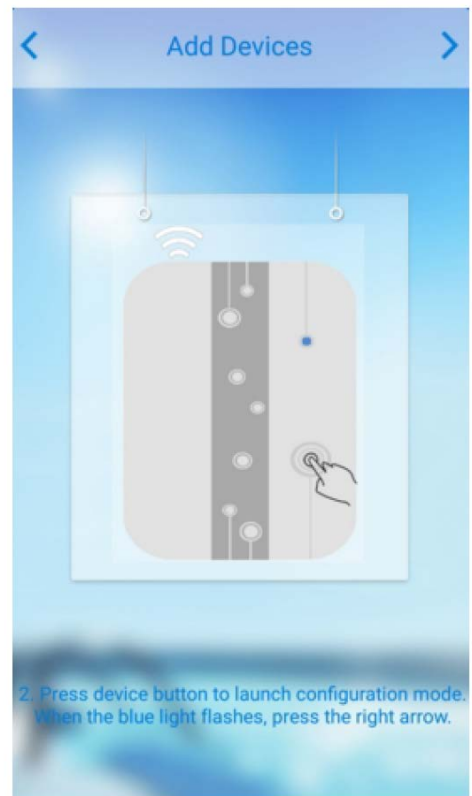

4. Operation & Use of the Smartphone App

4.1 Main Icons and Functions

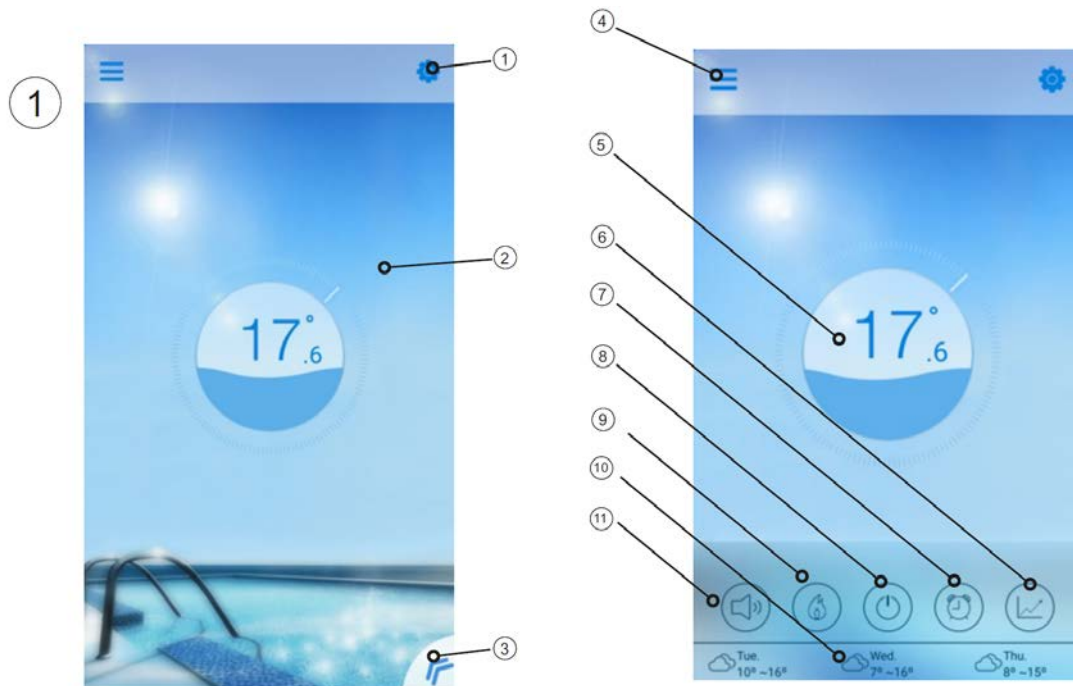

NO.	ICON	NAME	FUNCTIONS
①		Setting	Press to set the software.(see page.14)
②		Target temp. Pointer	Press and hold to slide and adjust target temperature(see page.11)
③		Menu button	Press the menu button, it will show the function list.
④		Device list	Device list, press it and goes to device list.
⑤		Status Display	The number show the current pool water temperature .Ripple on behalf of the machine switch.
⑥		Temperature curve	Press to show the temperature curve about latest temperature record in a month.(see page.13).
⑦		timer	Click it to enter the timer on/off and mute timer setting interface(see page.11).
⑧		On/off button	Press to control the on/off state of the unit.
⑨		Mode shift	Click it to shift running mode of equipment among three modes: Cooling, heating and Auto.The cooling mode does not display this icon.(see page.10.)
⑩		Weather	Display the weather in three days
⑪		Mute conversion	Click it to shift running mode of equipment among two modes: mute and un-mute (see page.12)

4.2 Main Functions

4.2.1 Turning ON/OFF

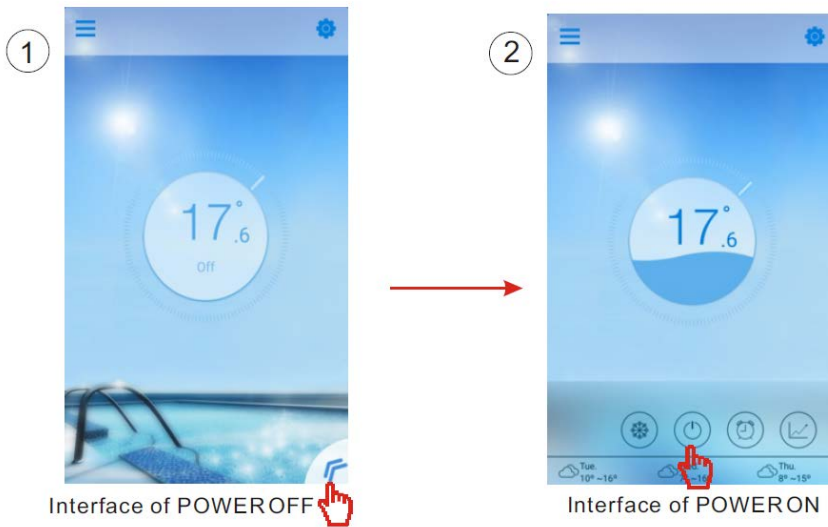

4.2.2 Mode Shifting

Click the “Mode shift” icon to shift running mode of equipment. The sequence of shifting is “Cooling→Heating→Auto” and that cycle repeats.

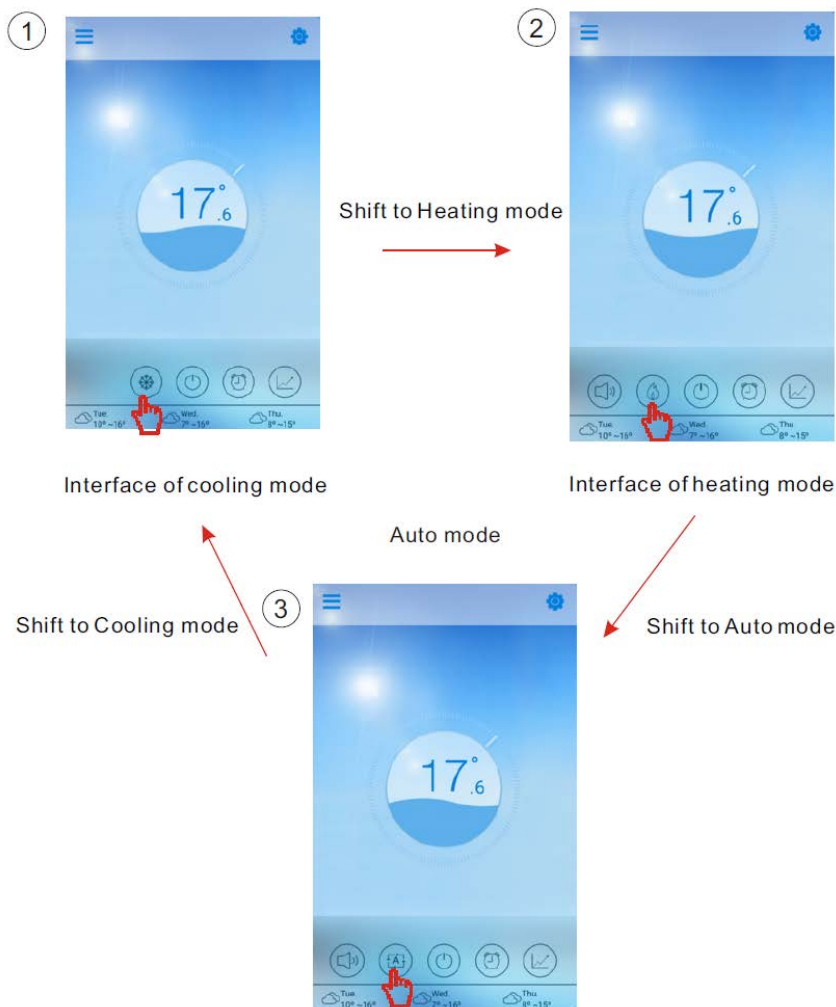

4.2.3 Setting the Temperature

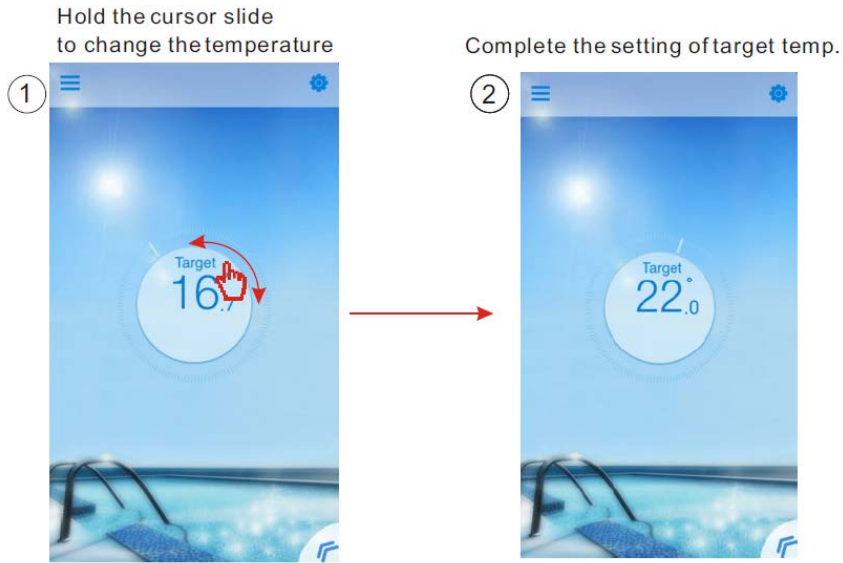

4.2.4 Timer Setting

- (1) Click "Timer" icon to enter the timer setting interface.
- (2) Click "<" to return to previous interface.
- (3) 2 independent groups of timer are provided for setting.



Save it after setting

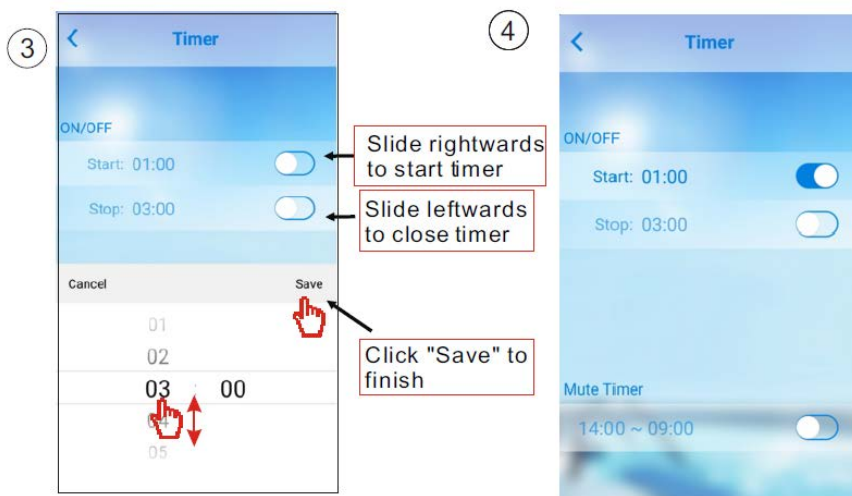

4.2.5 Silence Mode

Click “mute” icon to shift the Silence Mode(ON/OFF).

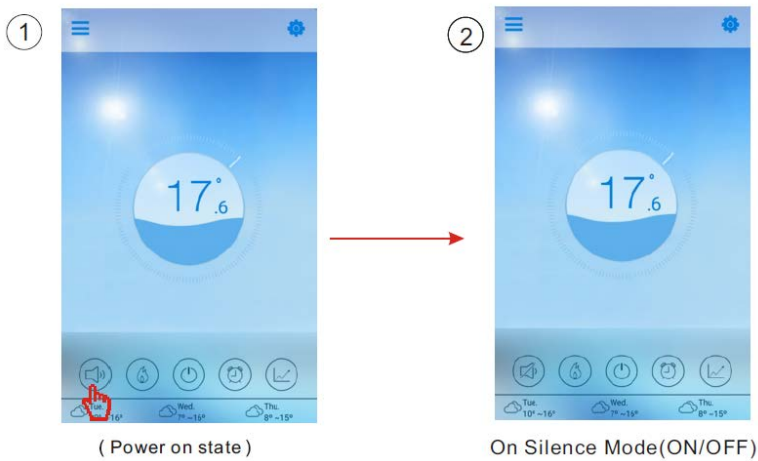

4.2.6 Timing Mute

Click “Timer” icon

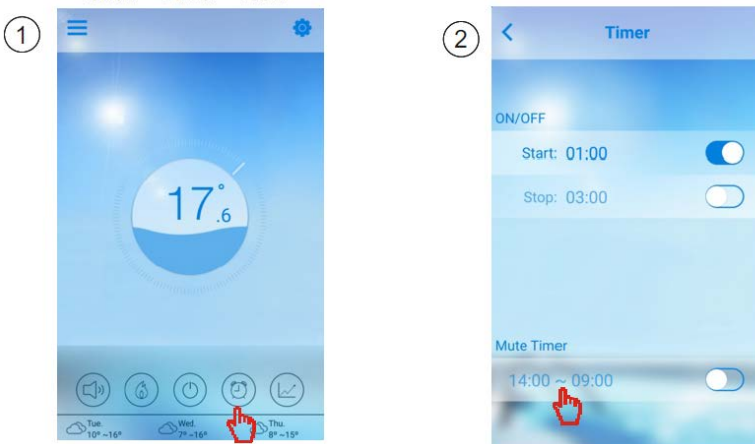

4.2.7 Checking the Temperature Curve

- a. You can get current or history (up to past 30 days) informations of variation of temperature by easily sliding the pointer.
- b. With two fingers you can zoom in/out the Temp. curve.

Press the curve button

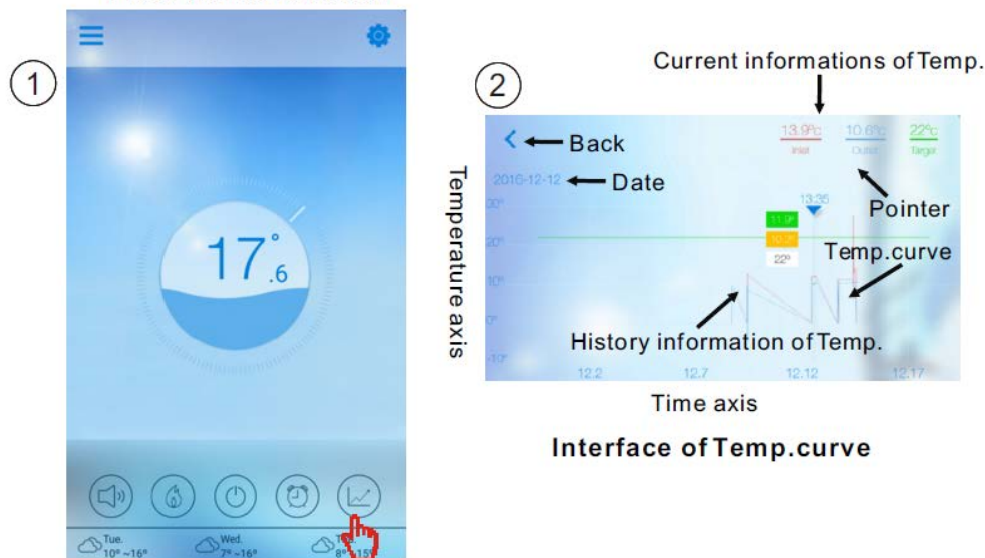

4.3 Other Functions

Click the 'Settings' icon to enter the settings menu.

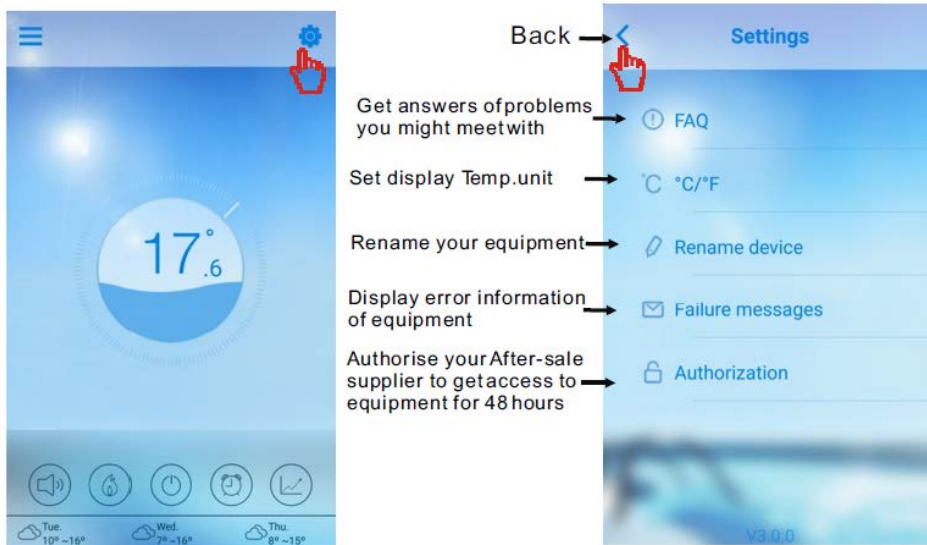

FAQ	ANSWER
Internet Access successful:	Green Light
How to fix a connection issue due to having too much distance between the home router and the wi-fi module.	<ol style="list-style-type: none"> 1. Use a 10m extension cable, please contact your supplier. 2. Use a Wi-Fi range extender (not supplied)

Check the Failure Information of the heat pump

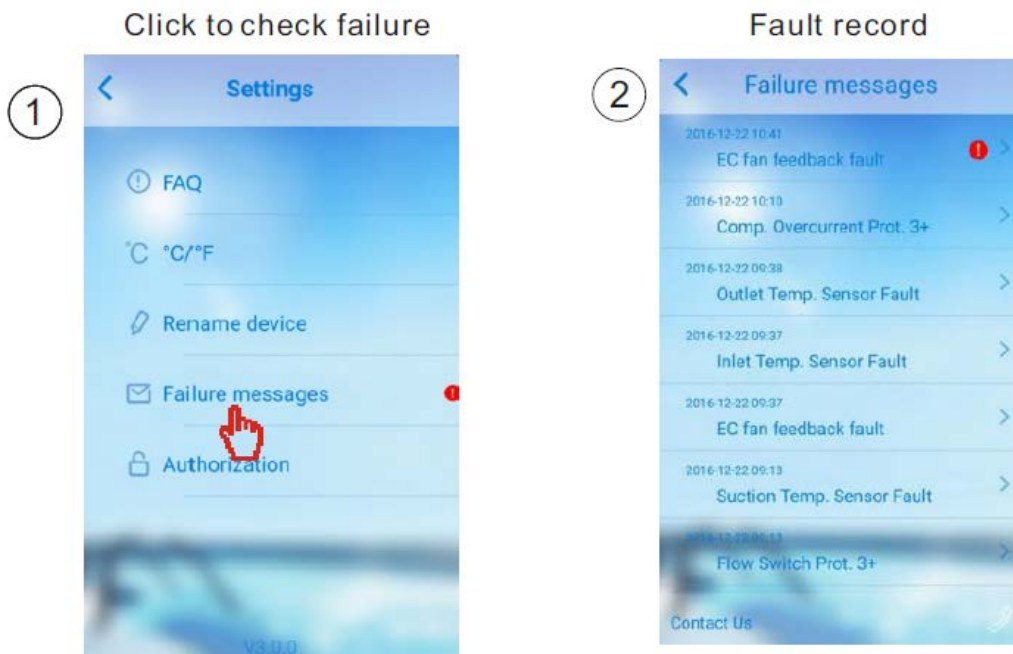

Note: If the machine fails, please clear the fault promptly.

5. FAQ

Q: When the App cannot connect to the device, it shows “Failed to connect to device”, what does this mean?

A: The network is abnormal, please check your network.

Q: When the App cannot connect to the device, it shows “Device offline”, what does this mean?

A: The Wi-Fi module connected has dropped, please check the connection of the Wi-Fi module, or restart and connect the module again.

Q: The distance between my device and router is too long, which results in a signal instability. How do I resolve this?

A: Try to add another router between the original router and the equipment in order to relay the signal.

Q: Something went wrong with my equipment, what should I do?

A:

1. Check for an error message in the settings menu or displayed on your wire controller.
2. Look up the corresponding error code in the instructions of your equipment to find out the problem.
3. Contact your supplier for after-sales maintenance if necessary.

